

### Annual Maintenance Instructions for P8A Tailwheel

- Grease at the grease zerks (A14) (2 Places) with a good quality bearing grease.
- Lubricate the lock pin (13AB) with light machine oil or spray oil (WD 40 or equiv.)
- Ensure the moving parts in the steering arm are free from binding, but without excessive play.
- Ensure the steering springs/chains are pre-loaded by approximately ¼ inch.
- Ensure tire pressure in the pneumatic tire is sufficient to carry the weight of the tail of the aircraft (20-45 PSI).

- |     |                               |      |                                      |      |                  |
|-----|-------------------------------|------|--------------------------------------|------|------------------|
| 1   | Cotter Pin 5                  | 23   | 6:50 x 2:50 Tire                     | 61A1 | SFSA Fork W/Axle |
| 2   | Nut                           | 23   | 6:50 x 2:50 Tire with Bearings       | 63   | Cover Cap        |
| 3   | 1/16 Proj. Bearing (F-350-12  | 26   | Felt                                 | 63A  | Cover Cap        |
| 4   | 1/16 Proj. Bearing (F-350-12  | 27   | Hub Cap with Zerk & Screws           | *    | Cover Cap Tool   |
|     | Inc. # 28 Washer              | 28   | Washer                               | 64   | Washer           |
| 5   | Axle with TW-6 Sirclip Ring   | 30   | Inside Hub with Bearings             |      |                  |
| 6   | Sirclip Ring 2                | 31   | Outside Hub                          |      |                  |
| 7   | Zerk Fitting                  | 32   | Hub Cap                              |      |                  |
| 8   | Cam Screws 2                  | 33   | Sirclip Ring                         |      |                  |
| 9   | Screw 3                       | 34   | 4/16 x 3/4 Hub Bolts 3               |      |                  |
| 10  | Cam                           | 35   | 5/16" Lock Washer 3                  |      |                  |
| 11  | Nut 3                         | 38   | P8 Wheel, Tire, & Tubes Assy.        |      |                  |
| 12  | Plate                         |      | Inc. Pts. 7, 17, 18, 19, 30, 31, 32, |      |                  |
| 13  | Lock Pin                      |      | 33, 34, 35                           |      |                  |
| 13A | Lock Pin                      | 45   | Washer                               |      |                  |
| 14  | Spring                        | 57   | Lock Ring                            |      |                  |
| 15  | Steering Arm Assy.            | 57A  | Lock Ring                            |      |                  |
| 15A | Steering Arm Assy.            | 58   | P8 Fork                              |      |                  |
| 16  | Nut                           | 58A  | P8A Fork                             |      |                  |
| 16A | Nut                           | 58-1 | P8 Fork W/Axle                       |      |                  |
| 17  | 2.80/2.50 x 4 Tube            | 58A1 | P8A Fork W/Axle                      |      |                  |
| 18  | 2.80/2.50 x 4 Tire            | 59   | Oilite Bearing                       |      |                  |
| 19  | Bearing                       | 59A  | Oilite Bearing                       |      |                  |
| 22  | Bracket Assy. 1 1/4", 1 1/2,  | 60   | Lock Ring Pin 2                      |      |                  |
|     | or 1 3/4 Inc. Pts. 7, 8, 10 & | 60A  | Lock Ring Pin 2                      |      |                  |
|     | 59                            | 61   | SFS Fork                             |      |                  |
| 22A | Bracket Assy. 1 1/4", 1 1/2,  | 61A  | SFSA Fork                            |      |                  |
|     | or 1 3/4 Inc. Pts. 7, 8, 10 & |      |                                      |      |                  |
|     | 59A                           |      |                                      |      |                  |

NOTE: Letter "A" after number is for the New Type Tailwheel

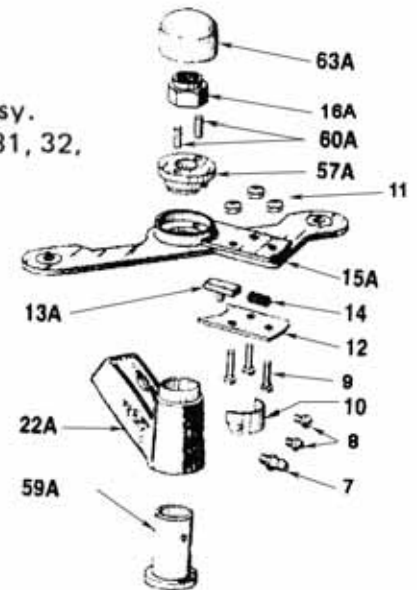

### SFS-P8A SERIES

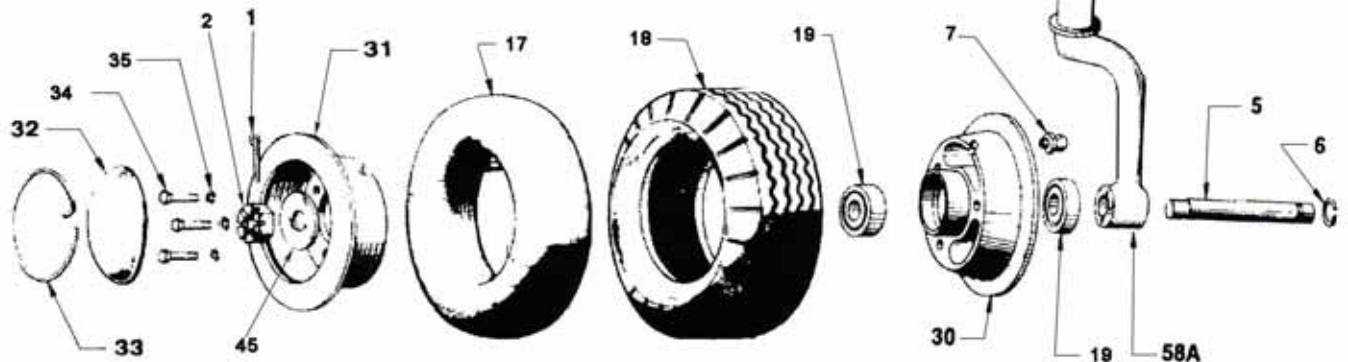

**TAILWHEEL ASSEMBLY - PIN TW-100. TW-101 & TW-102**

Typical Tailwheel Installation Instructions

- Step 1) Remove old tailwheel and install new tailwheel (7) by mating bracket (8) with aircraft leaf spring and securing with bolt (6), nut (4) and cotter pin (5).
- Step 2) Attach connector spring assemblies (1) (See Note 1) to rudder control horn on aircraft using connector clips (3) or quick links (10). Attach connector chains (2) to connector spring assemblies (1) and secure to tailwheel steering arm (9) with connector clips (3) or quick links (10). Note: When using (3) clips, safety wire clips as shown below. Note: When using (10) quick links, tighten link nut snug with hand tool and secure with cotter pin (11).
- Step 3) Compress the left side connector spring assembly (1) approx. 3/4 inch and adjust the connector chains (2). The tailwheel and rudder must be maintained in the neutral position when adjusting the spring tension. Cut off excess connecting chains (2).
- Step 4) Check Tire pressure for P8A and P8B Models: 45 psi depending on weight (tire should be slightly flat on bottom).

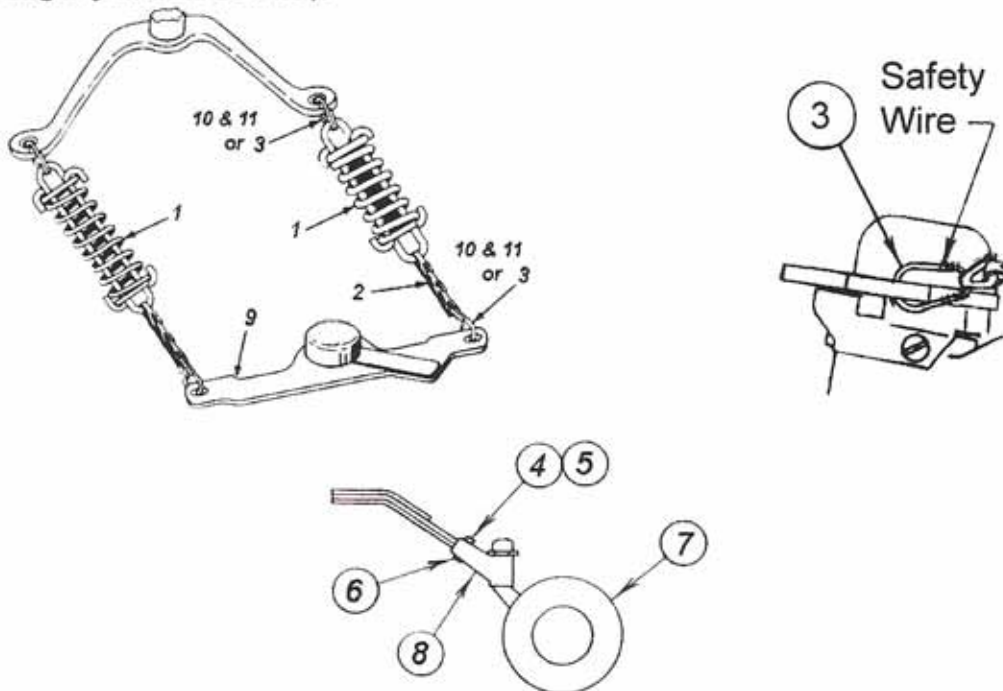

BILL OF MATERIAL FOR TYPICAL INSTALLATION

1	Connector Spring Assembly - Left	TW-55	1
	Connector Spring Assembly - Right	TW-56	1
2	Connector Chain	TW-48	2
3	Connector Clip (Optional to Item 10)	TW-49	4
4	Nut	AN310-7	1
5	Cotter Pin	AN380-3-3	1
6	Bolt	AN-7- As Required	1
7	Tailwheel Assembly	See Page 1	1
8	Bracket	Part of Assembly	
9	Steering Arm	Part of Assembly	
10	Quick Link	TW-85	4
11	Cotter Pin	MS24665-151 or -132	4